

PINOUT CONFIGURATION

HDMI FEMALE	HDMI FEMALE
1	1
3	3
2	2
4	4
6	6
5	5
7	7
8	8
9	9
10	10
12	12
11	11
13	13
14	14
15	15
16	16
17	17
18	18
19	19
SHELL	SHELL

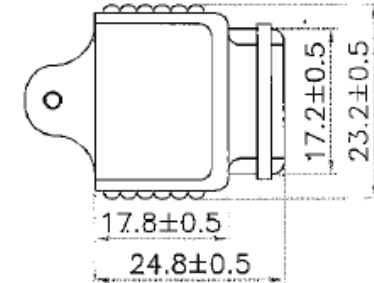
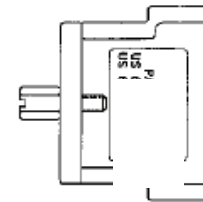
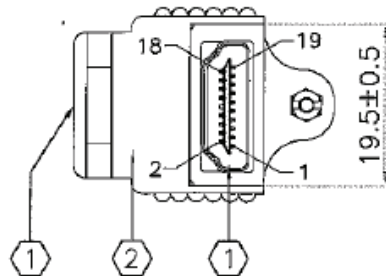

UNIT: mm

ITEM	DESCRIPTION	QTY.	UNIT
1	HDMI TYPE A 19PIN FEMALE CONNECTOR W/GOLD PLATED PINS	2	PCS.
2	PAT.US 6,287,148 B1 RF-BLOK™ SHIELDING METAL CAN NICKEL PLATED	1	PCS.
3	M3 NICKEL PLATED JACKSCREW	2	PCS.

HDMI Female to Female Adapter 90° with Lock-System. Fully metal shield.

HDMI Buchse auf Buchse Adapter 90° mit Lock-System. Vollständige Metallabschirmung.



WEEE-Reg.-Nr. DE 38986660

Date:
11.08.2022

SP

Checked by:
11.08.2022

FM

Datasheet:

CK-ADHDMI-FF-W

